

ActivPanel[®]

Titanium[™] with USB-C



DISPLAY

Diagonal Size	70" 4K, 75" 4K, 86" 4K
Screen Type	TFT LCD (Direct LED Backlight)
Aspect Ratio	16:9
Display Area	70" 4K: 1541 x 868 mm (60.7 x 34.2 in) 75" 4K: 1652 x 930 mm (65 x 36.6 in) 86" 4K: 1895 x 1066 mm (74.6 x 41.9 in)
Display Colours	1.07 Billion
Resolution	4K UHD (3840 x 2160 @ 60 Hz)
Response Time	8 ms
Panel Refresh Rate	60 Hz
LED Lifespan	50,000 hours
LCD Viewing Angle	178°
Brightness	70" 4K: 370 cd/m2 75" 4K: 370 cd/m2 86" 4K: 400 cd/m2
Contrast Ratio	4000:1
Ambient Light Sensor	Yes
Glass Hardness	9H (Pencil), 7 (Mohs)
Glass Type	Heat-tempered, Anti-Glare

INTERACTIVITY

Angled Centre Console	Yes, with Power, Volume Control, Menu, Freeze, No Touch, Source Selection Buttons
Touch Technology	Vellum [™] Writing Technology
Continuous Touch Points	20
Touch Resolution	32768 x 32768 px
Response Time	≤5 ms
Touch Accuracy	1 mm
Tracking Rate	6 m/s
Scan Rate	200 Hz
Gestures and Edge Swipes	Windows [®] Supported
Eraser Included (Block Eraser)	1
Pens Included	4 with Rear Erasing Feature
Pen Type	Battery-less Pen
Pen Holder	Integrated Full-length Pen Tray
Pen Tip Diameter	3 mm
Pen and Touch Differentiation	Yes
Pen Identities	2
Palm Detection	Yes
Annotation Over Any Source	Yes
Classroom Essential Apps	Including Whiteboard, Annotate, Timer, Spinner, Screen Capture, Screen Share, Browser, PDF Reader, Media Players
Compatibility	Windows [®] 8 to 10; OS X [®] 10.8 to 10.11 macOS [®] Sierra 10.12.1 or later; Linux [®] Ubuntu [®] 18.04 LTS; Chrome OS [™]

CONNECTIVITY

HDMI [®] 2.0 In (Rear)	1
HDMI 2.0 In (Front)	1
HDMI 2.0 Out	1
Display Port 1.2 In	1
VGA In	1
VGA Audio In	1
USB-A 2.0 (Rear)	2
USB-A 3.0 (faster data transfer, Rear)	1
USB-A 3.0 (faster data transfer, Front)	2
USB-B Touch (Rear)	2
USB-B Touch (Front)	1
USB-C (PD3.0/ USB3.0 inc Touch/ DP1.2, Rear)	1
LAN In (RJ45)	1x 10/100/1000 Mbps
LAN Out (RJ45)	1x 10/100/1000 Mbps
Wake-on-LAN	Yes
Wi-Fi [®] Module IEEE [®] 802.11a/b/g/n/ac	Included
Wireless, 2x2	
Bluetooth [®] 4.2	Yes
RS-232	Yes
CVBS	1
Mic In (3.5 mm)	1
Headphone	1
Proximity Sensor for Warm Boot	Yes
OPS Slot	1

COMPUTING

Operating System	Android [™] Oreo 8
RAM	4 GB
Internal Storage	64 GB (32 GB x2)
CPU	Quad Core: (2) ARM Cortex A73, (2) ARM Cortex A53
GPU	ARM Mali-G51 MP4
Remote Over-the-Air Updates	Yes
Promethean Panel Management	Yes

AUDIO

Dual Front Facing, Bass Enhanced Speakers	70" 4K: 2 x 15 Watts 75" 4K: 2 x 15 Watts 86" 4K: 2 x 20 Watts
---	--

ActivPanel[®]

Titanium™ with USB-C

POWER

Power Requirements	100V - 240V AC
Power Consumption (Typical)	70" 4K: 115W 75" 4K: 124W 86" 4K: 195W
Power Consumption (Standby)	<=0.5 W
Ultra-Quiet Fanless Design	Yes

ENVIRONMENTAL

Operating Temperature	0°C to 40°C (32°F to 104°F)
Storage Temperature	-15°C to 55°C (-5°F to 131°F)
Operating Humidity	20% to 80% non-condensing humidity
Storage Humidity	20% to 90% non-condensing humidity

PHYSICAL SPECIFICATIONS

Panel Dimensions	70" 4K: 1668 x 1033 x 95 mm (65.7 x 40.7 x 3.7 in) 75" 4K: 1764 x 1089 x 109 mm (69.4 x 42.9 x 4.3in) 86" 4K: 2014 x 1231 x 109 mm (79.3 x 48.5 x 4.3 in)
Packed Dimensions	70" 4K: 1796 x 1145 x 278 mm (70.7 x 45.1 x 11.0 in) 75" 4K: 1895 x 1200 x 278 mm (74.6 x 47.2 x 11.0in) 86" 4K: 2140 x 1350 x 278 mm (84.3 x 53.1 x 11.0in)
Net Weight	70" 4K: 53 kg (117 lbs) 75" 4K: 60 kg (132 lbs) 86" 4K: 75 kg (165 lbs)
Packed Weight	70" 4K: 75.5 kg (166.4 lbs) 75" 4K: 85.5 kg (188.5 lbs) 86" 4K: 101.6 kg (224.0 lbs)
Wall Mount Dimensions	1010 x 720 x 52 mm (39.8 x 28.3 x 2.0 in)
VESA Mount Point	70" 4K: 600 x 400 mm (23.6 x 15.7 in) 75" 4K: 800 x 400 mm (31.5 x 15.7 in) 86" 4K: 800 x 400 mm (31.5 x 15.7 in)

COMPLIANCE & CERTIFICATION

Regulatory Certifications	CE, FCC, IC, UL, CUL, CB, RCM
Energy Star Certified	70" 4K: Yes 75" 4K: Yes 86" 4K: Yes

EDUCATION SOFTWARE LICENSE

ActivInspire [®] Professional	Included
Single User	

PACKED CONTENTS

What's in the Box	(1) ActivPanel Titanium (1) 3M Length HDMI Cable (1) 3M Length USB Cable (A-B) (1) 3M Regional Power Cable (1) 2M Length USB-C Cable (1) Remote Control (2) Batteries for Remote Control (4) ActivPanel Titanium Pens (1) Block Eraser (1) Sealed Antistatic Bag (4) VESA mount screws (M6) (1) Mini PC Bracket with screws (1) Quick Install Guide (1) Promethean Wi-Fi/Bluetooth Module (Ti) (2) Antenna (1) Promethean Wi-Fi/Bluetooth Module (Ti) User Guide (1) Wall Mount
-------------------	--

INSTALLATION

The installation of this product should be completed by a qualified installer. Use of components not supplied by Promethean or not meeting minimum specifications may impact performance, safety and warranty. For more information, visit Support.PrometheanWorld.com.

WARRANTY

Warranty term and upgrade options vary by region. Contact your local reseller or distributor for information and visit PrometheanWorld.com/Warranty.

SUPPORT

For all Promethean products, visit Support.PrometheanWorld.com.

ActivPanel[®]

Titanium™ with USB-C

TECHNICAL DRAWINGS

70"

Front

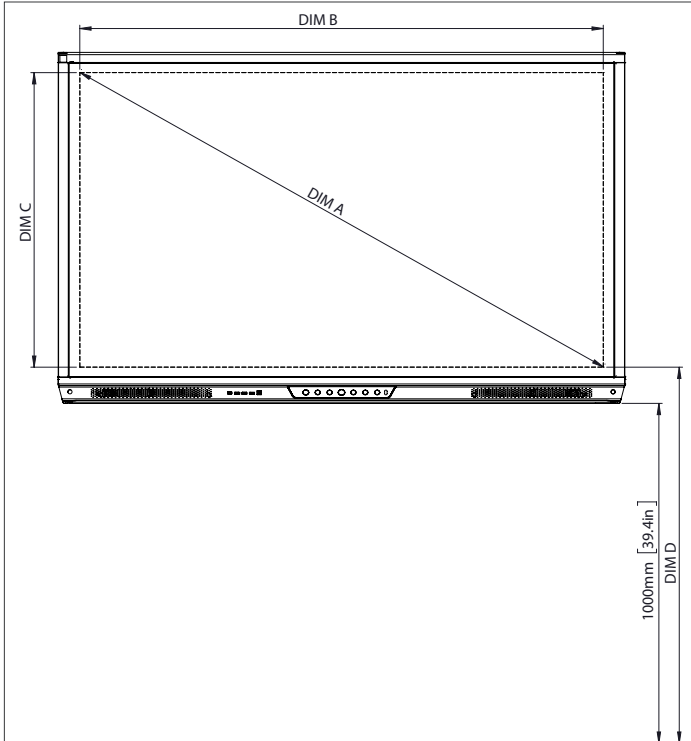

DIM	DIMENSIONS (MM)	DIMENSIONS (IN)
A	1768	70.0
B	1541	60.7
C	867	34.1
D	1107	43.6
E	136	5.4
F	67	2.6
G	1033	40.7
H	1668	65.7
I	600	23.6
J Min	157	6.2
J Max	295	11.6
K Min	1157	45.6
K Max	1295	51.0
L	95	3.7

Back

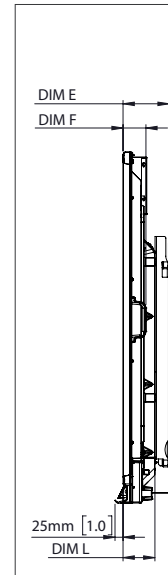
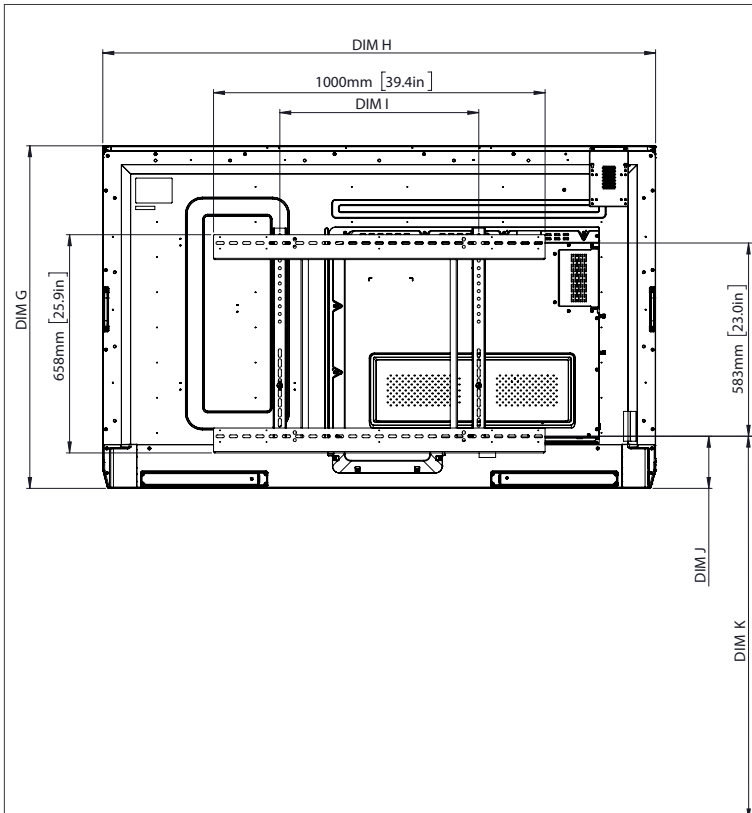

Side

ActivPanel[®]

Titanium with USB-C

TECHNICAL DRAWINGS

75"

Front

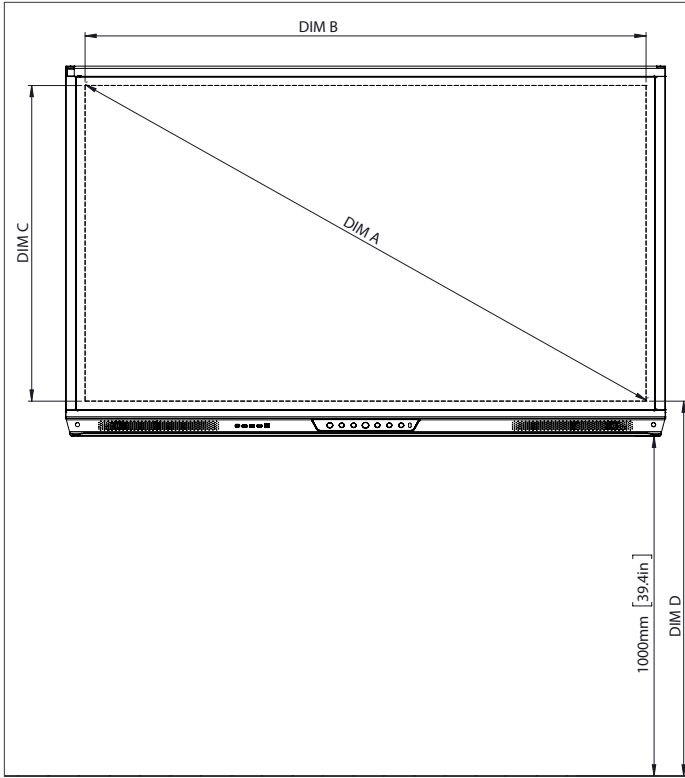

DIM	DIMENSIONS (MM)	DIMENSIONS (IN)
A	1894	75.6
B	1651	65.0
C	928	36.5
D	1103	43.4
E	133	5.2
F	67	2.6
G	1089	42.9
H	1764	69.4
I	800	31.5
J Min	214	8.4
J Max	352	13.9
K Min	1215	47.8
K Max	1353	53.3
L	109	4.3

Back

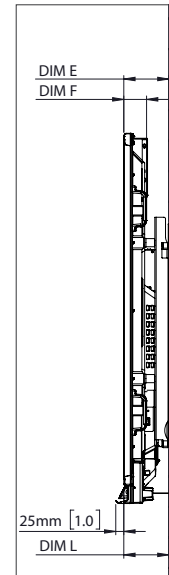
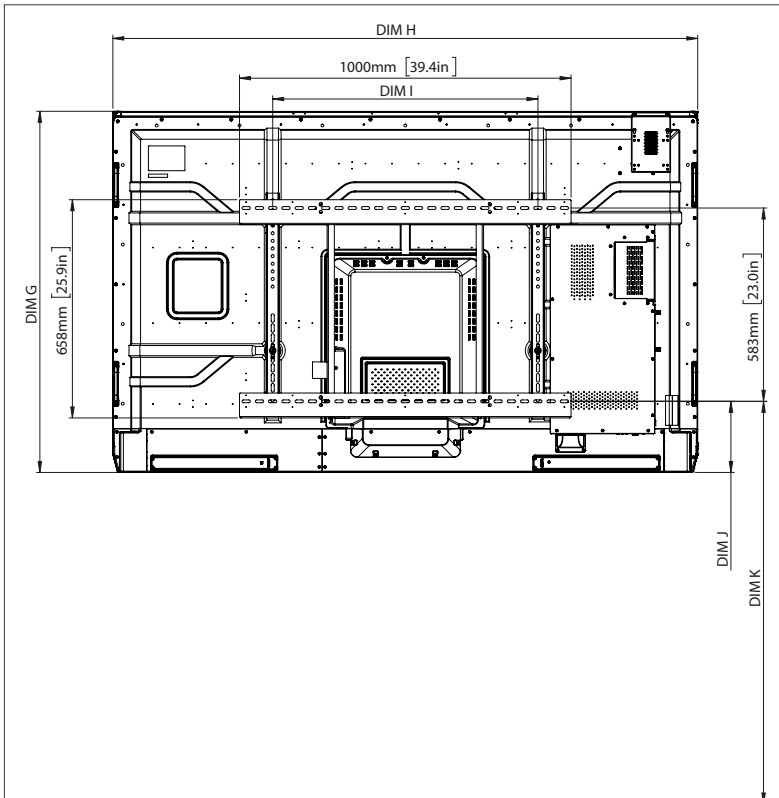

Side

ActivPanel[®]

Titanium™ with USB-C

TECHNICAL DRAWINGS

86"

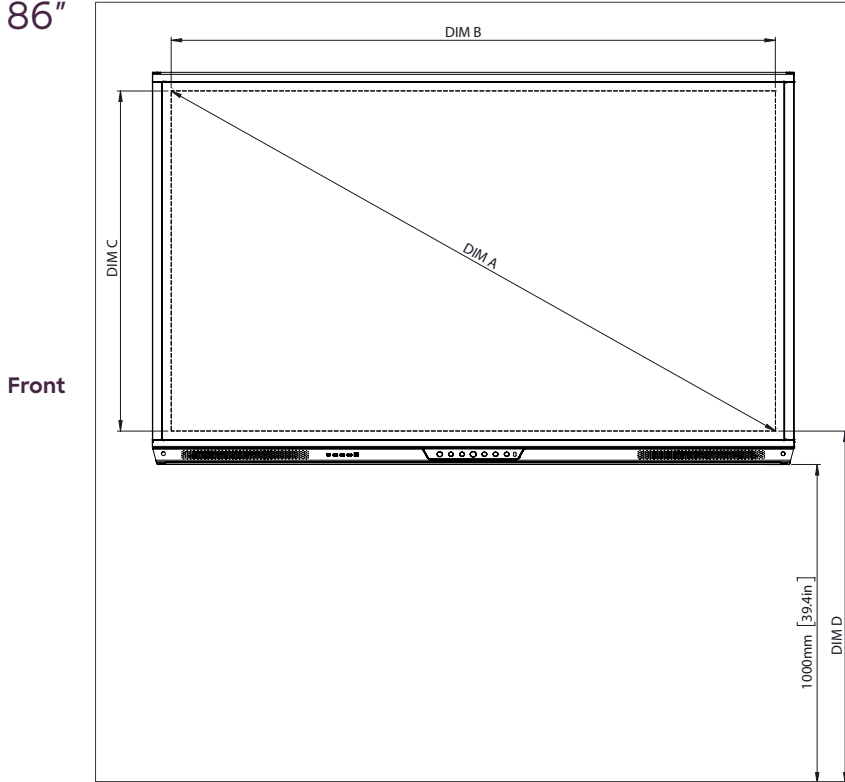

DIM	DIMENSIONS (MM)	DIMENSIONS (IN)
A	2176	85.6
B	1896	74.7
C	1067	42.0
D	1107	43.6
E	134	5.3
F	67	2.6
G	1231	48.5
H	2014	79.3
I	800	31.5
J Min	286	11.3
J Max	424	16.7
K Min	1286	50.6
K Max	1424	56.1
L	109	4.3

Back

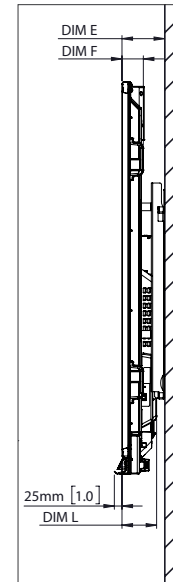
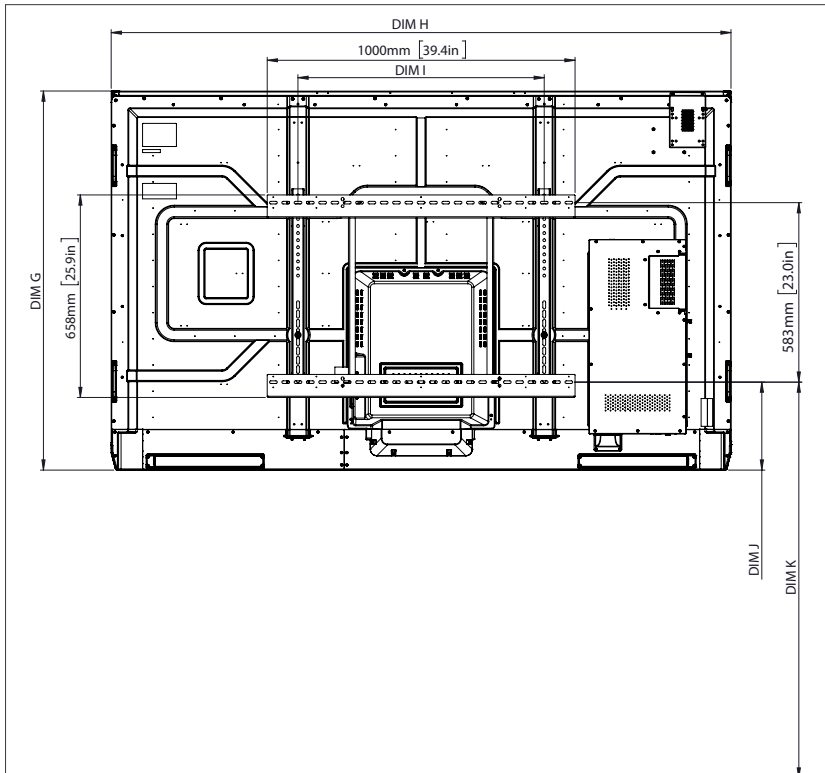

Side



ActivInspire® is a single software platform that combines the best of our award-winning programs in one package. ActivInspire makes it easy for teachers to deliver interactive lessons and engage students with multimedia rich content.

SYSTEM REQUIREMENTS

Operating Systems	Windows® 7 SP1 (32 & 64-bit), Windows 8 (32 & 64-bit), Windows 10 (32 & 64-bit); macOS® 10.13, macOS 10.14; Linux® Ubuntu® 16.04, Linux Ubuntu 18.04
PC Minimum	2.0 GHz processor (Intel Core i3 or faster), 1024 x 768 resolution, 4 GB of RAM, 2.5 GB of free disk space
Mac Minimum	2.0 GHz processor (Intel Core i3 or faster), 1024 x 768 resolution, 4 GB of RAM, 4 GB of free disk space
Linux Minimum	2.0 GHz processor (Intel Core i3 or faster), 1024 x 768 resolution, 4 GB of RAM, 2.5 GB of free disk space

SOFTWARE EDITIONS

ActivInspire Professional Edition	Fully loaded version that combines the best of our award-winning programs in a single software platform. ActivInspire Professional Edition is available for purchase separately or is included with ActivPanel® Elements series, ActivPanel, ActivPanel i-Series, and ActivBoard® Touch.
ActivInspire Personal Edition	ActivInspire Personal Edition is available as a free download. Pricing and distribution conditions may apply in specific countries. Please check with your local Promethean representative for details on ActivInspire Personal Edition in your region.

COMPARISON CHART

PREPARATION	PROFESSIONAL	PERSONAL
Dashboard	√	√
Local Resource Search	√	√
Multi-Page Select	√	√
Object Layering and Reordering	√	√
Grid Mask	√	√
Text Editing	√	√
Actions Authoring	√	√
Marquee Select	√	√
Design Mode	√	
Themed Templates	√	
Object Align	√	
Rubber Stamp	√	
Drag a Copy	√	
Grid Designer	√	
Uniquely Label Objects	√	
Page Notes	√	
Shapes Library	√	
<hr/>		
MULTIMEDIA		
Play Flash Objects	√	
Supports .FLV files	√	√
Link Documents in Flipchart	√	√
Graphics/Image Support	√	√
Screen Recorder	√	√
Sound Recorder	√	
Asian Vertical Text	√	
<hr/>		
IMPORT FORMATS		
Import SMART Notebook™	√	√
Import SMART Gallery™	√	√
Import PowerPoint® (Windows)	√	√
Import QTI XML	√	
Import PDF	√	
Export PDF, BMP & JPEG	√	√
<hr/>		
LEARNER RESPONSE		
Integrated ActiVote and ActiVExpression	√	√
Question Manager	√	
Import ExamView® and XML Files	√	
Export LRS Questions and Answers to Excel®	√	
Self-Paced Learning	√	
Express Poll	√	√
<hr/>		
CLASSFLOW® INTERGRATION		
Compatible with most student devices	√	
Share flipcharts with student devices	√	
Remote control lesson with ClassFlow app	√	
Send Express polls to student devices	√	

COMPARISON CHART (CONTINUED)

AT THE BOARD	PROFESSIONAL	PERSONAL
Timer	√	√
Fill Tool	√	√
Page Scale	√	√
New Browsers (Actions, Page, Resource, Object, Property, Voting)	√	√
Right Click/Context Menu	√	√
Pen Tool & Pen Width Indicator	√	√
Duplicate	√	
Reset Page Tool	√	
Page Zoom Tool	√	
XY Origin	√	
Teacher Lock	√	
Desktop Annotation	√	
Dual-User Mode	√	
Pen Modifiers	√	
INTERACTIVITY & ENGAGEMENT		
Assign Actions to Objects and Pages	√	√
Magic Ink & Destructive Eraser	√	√
Application Settings	√	√
Keyboard Shortcuts	√	√
Dotted and Dashed Lines	√	√
Localized Versions	√	√
ActiView	√	√
Objects with actions can be dragged	√	
Customized Profiles	√	
Resize Icons	√	
User Defined Buttons	√	
Drag-on Buttons	√	
Handwriting Recognition Tool	√	
Convert to Text Tool	√	
Shape Recognition Tool	√	
Convert to Shape Tool	√	
Page Turn Effects		
RICH POWER TOOLS		
Clock	√	√
Snap Object to Grid	√	√
Spotlight	√	√
Time Stamping	√	√
Color Picker	√	
Tickertape	√	
Compass Tool	√	
Revealer Tool	√	
Calculator	√	
On-screen Keyboard	√	
Dice Tool	√	
Spellcheck reviews entire flipchart	√	

LICENSING AND SUPPORT†

Licensing Information can be obtained from Support.PrometheanWorld.com/Product/ActivInspire.
Online Support for all Promethean Products available from Support.PrometheanWorld.com.

GENERAL SPECIFICATIONS

Pen and Touch Capability	Delivers extended learning opportunities via advanced dual-user pen and multi-touch capabilities (dependent on hardware used). Designed to support a new generation of applications and emerging technologies
Multi-user and Multi-touch Input	Images can be easily moved, scaled and rotated with finger touch in conjunction with real life "pen" tasks such as writing and drawing when connected to an ActivBoard 500 Pro, ActivBoard Touch or ActivPanel Touch
Cross-Platform	Compatible with major operating systems (Windows, Mac, Linux) and works across a wide range of interactive whiteboards and interactive flat panels
Intuitive Interface	Use of browser methodology makes navigation easier for all users and all levels of expertise
Easy, Quick Lesson Creation	Quick lesson building through the use of themed templates
ClassFlow Integration	Connect most student devices with iOS, Android, Chrome or Windows. Remote control using ClassFlow Teacher App. Add pages remotely using ClassFlow Teacher App. Send flipchart pages, Express Polls and Questions to student devices. Conduct self-paced tests with student devices. <u>Note:</u> ClassFlow Integration may not be available in your language
Learner Response Integration	Full integration with ActiVote and ActivExpression devices including Self-Paced Learning for ActivExpression (Professional Edition only)
Learner Response System Features	Question Manager - everything in one place to quickly create, edit and manage questions and question sets. Support Assessment for Learning with individuals, groups and whole classes. Instructors and participants gain immediate feedback via meaningful data (Professional Edition only)
Resources	ClassFlow offers free and premium resources online. Resource Packs and Flipcharts can be downloaded directly into ActivInspire Resource Library
Languages	Arabic, Azeri, Basque, Brazilian Portuguese (BRA), Catalan, Chinese Simplified, Chinese Traditional, Czech, Danish, Dutch, English (UK), English (US), Finnish, French, Galician, German, Greek, Hebrew, Hungarian, Indonesian, Irish, Italian, Japanese (horizontal text), Kazakh, Korean, Latvian, Lithuanian, Malaysian, Mexican Spanish, Norwegian, Polish, Portuguese (EU), Russian, Slovakian, Slovenian, Spanish, Swedish, Thai, Turkish, Turkmen, Vietnamese