

mondo



Mondo Tivoli.

buroseating.com

Mondo by
buro
ergonomics at work®

Mondo Tivoli.

Nifty aesthetics.

The Mondo Tivoli office chair has all the bells and whistles... where do we start? The curved aesthetic with mesh backrest leaves a lasting impression on the eye but the comfortable design will have you wondering where the Tivoli has been your whole working life! All these nifty features are super easy to adjust too - perfect!

Key Features & Benefits.

112-M3 Tivoli Task Chair



Front view

Back angle view

MODERN MESH

You will stay cool and comfortable with this curved breathable mesh backrest.

ADJUSTABLE BACK HEIGHT

Simple ratchet back feature helps achieve optimal lumbar support for every body.

CONTOURED

This mesh is designed to not only support you where it matters but also provide air flow.

TILTING SEAT & BACK

Adjusting the seat and back tilt will ensure you are always seated in a position to encourage circulation.



Features.

- Mesh backrest
- Ratchet height adjustable back
- Synchronised seat and back tilt
- Adjustable seat height

Specifications. (mm)

Overall	640w / 640d / 940h
Back	500w / 500h
Seat	500w / 470d
Seat Height	440-570h

Carton Dimensions.

Width	635
Height	335
Length	635
Weight	17 kg

Custom Options.

- Height adjustable arms (180-2)

Upholstery.

Dove



Black
5806
(M3)

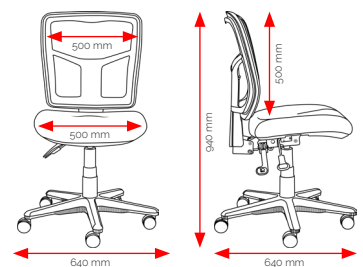

Quality Assurance and Accreditations.



Buro Product Stewardship Programme.

We encourage repurposing and recycling of pre-loved office furniture to reduce our impact on the environment. When a customer has Buro furniture* that they wish to dispose of, we apply the following steps to determine the most appropriate method.

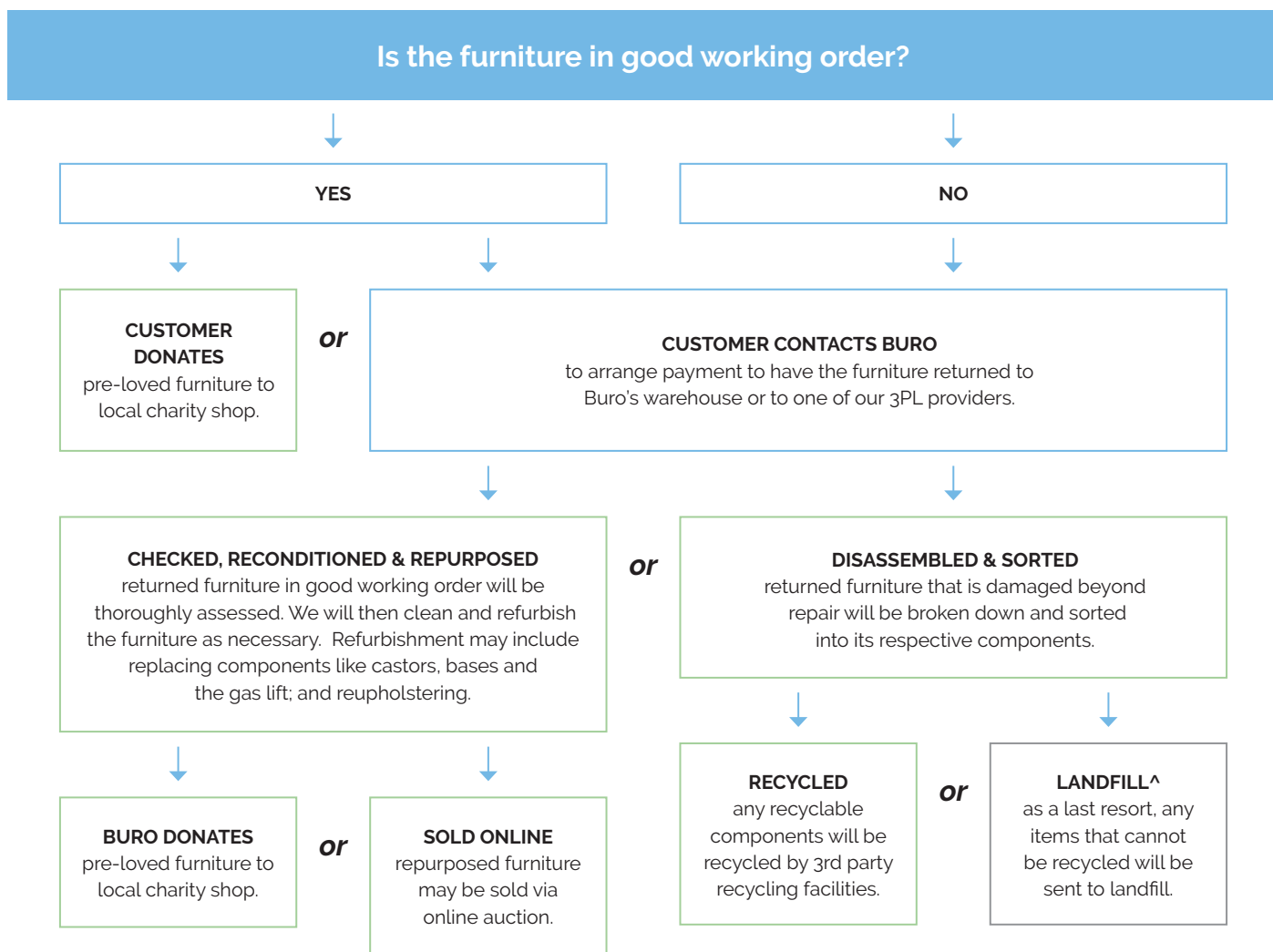

To mitigate our CO2 footprint over the next 50 years, we're working with **Trees That Count**, a conservation charity dedicated to planting native trees.

By funding the planting of native trees, we're supporting efforts to increase biodiversity across New Zealand.

Buro proudly support **Greening Australia**.

Greening Australia has been restoring Australia's unique landscapes and protecting biodiversity at scale through collaborative, science-based programs for over 40 years.
www.greeningaustralia.org.au

As a **Sedex member** we are committed to being a responsible business, sourcing responsibly, and improving ethical standards and working conditions within the supply chain.

*Qualifying furniture must be Buro branded product (Buro Seating, Konfurb, Mondo), or a partner exclusive brand.
^Many of our products are GREENGUARD certified for safe emission levels. This reduces the environmental impact when sending any components to landfill.

Assembly, Operating & Maintenance Instructions

Remove all items from the carton. Verify all pieces before assembly.

mondo

MONDO TIVOLI CHAIR - 2 LEVER

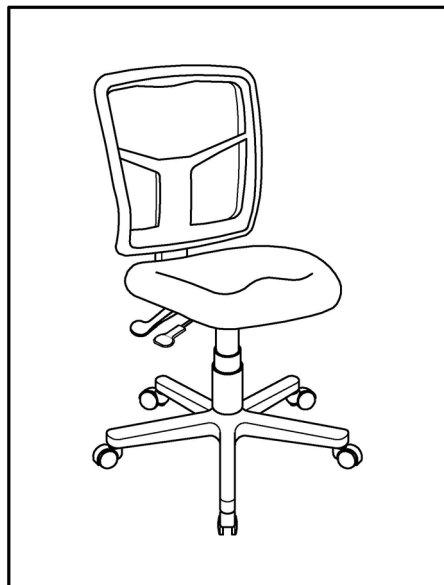
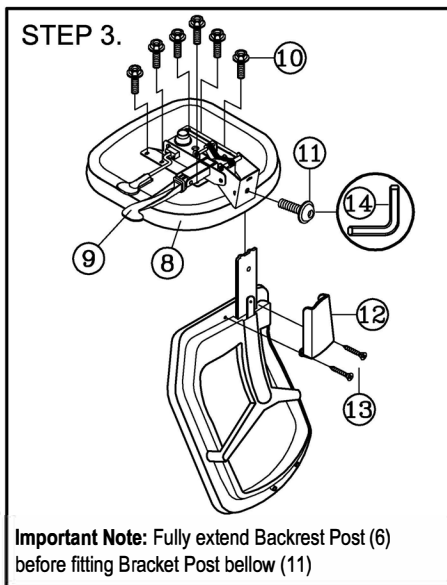
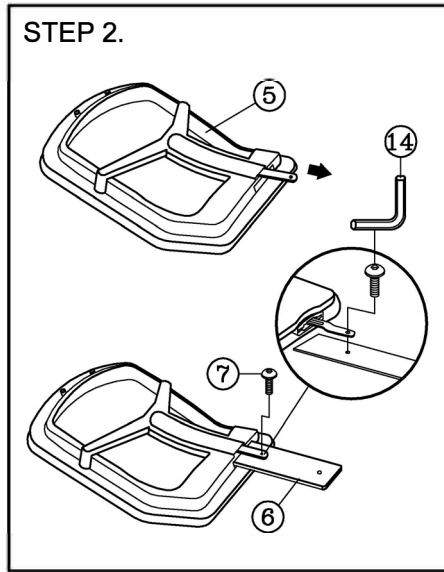
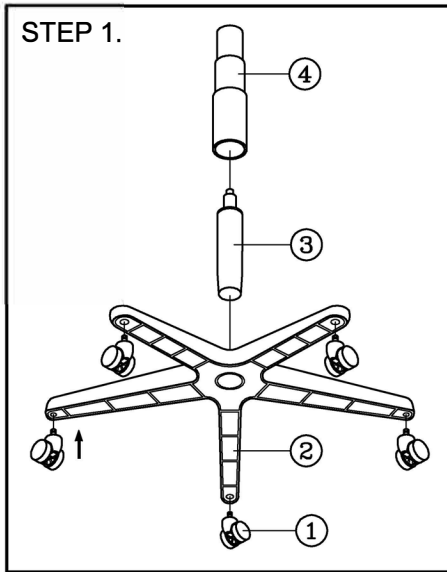

PARTS LIST

KEY	QTY	DESCRIPTION
1	5	Castors
2	1	Base
3	1	Gas Lift
4	1	Gas Lift Cover
5	1	Backrest
6	1	Backrest Post
7	1	Backrest Screw
8	1	Seat
9	1	Mechanism
10	6	Mechanism Screw
11	1	Back Tight Bolt
12	1	Back Post Bellow
13	2	Back Post Bellow Screw
14	1	M5 Size Allen Wrench

CARE & MAINTENANCE

GENERAL CARE

To maintain the appearance of non-upholstered parts wipe the surface with a clean cloth dampened with a mild detergent solution.
Do not remove any parts for separate cleaning.
Do not saturate the fabric or interior with water or other cleaning liquids.
Do not shampoo clean.
Do not clean with hot water extraction machine.
Do not clean with onsite drycleaning machine.
Protect from direct sunlight, heat and weather.

FABRIC UPHOLSTERY CARE

Wipe with a clean cloth dampened with a mild upholstery detergent solution.
A soft bristle brush may be used to remove ingrained soil. Spot clean as above.
Treat spills and stains as soon as possible. Persistent stains may require treatment by a professional cleaner.
May be cleaned with dry powder cleaners.
Allow to dry thoroughly before reuse.

FOAM & UPHOLSTERY SPECS*

FOAM

Flame Resistance: Ca117 Section A Part I & Section D Part II

UPHOLSTERY : FABRIC

Flame Resistance: Ca117 Section E Class I

*This applies only to standard Buro stock.
Any customer specified upholstery may not meet these specifications.

PREVENTATIVE MAINTENANCE & WARNING!

- Use this product only for seating one person at a time.
- Do not use this chair as a step stool / ladder.
- Do not sit on any part of the chair except the seat.
- Do not use this chair on uneven floor surfaces.
- Do not interfere with the operating of the gas lift.
- Do not use chair unless all bolts, screws and knobs are tight. At least every six months check all bolts, screws and knobs to ensure they are tight.
- If any parts are missing, broken, damaged or worn do not use the product until repairs are made using factory authorised parts.
- Dispose of packaging properly.
- Plastic bag is not a toy.
- Do not use plastic bag as a head covering as it may cause suffocation.
- Failure to follow these warnings could result in serious injury.

MECHANISM OPERATING INSTRUCTIONS

IMPORTANT NOTE:

Do not operate the mechanism levers unless properly seated in the chair.

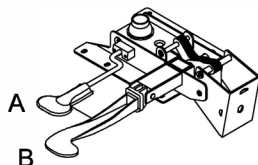

- A** Pneumatic seat height adjustment
- B** Seat & backrest angle adjustment :
Seat and back angle adjust simultaneously with a single lever.

OPERATING INSTRUCTIONS!

RECOMMENDED SEATING POSITION & ADJUSTMENTS:

- Sit in the chair, adjust the seat tilt so that it is approximately horizontal or inclined slightly forward, to allow an angle greater than 90° at the knees and the hips.
- Adjust the seat height so that your feet are resting flat on the floor. For good circulation, your lower legs should form a 90° angle with the floor, with your feet taking the weight of your legs.
- Adjust the backrest tilt function accordingly, to give your back firm support while sitting upright.
- Adjust the height of the backrest to give support to the lumbar region of your back.
- Your forearms should be close to horizontal as possible when working at a desk.

BACKREST INSTRUCTIONS:

- The backrest (6) height adjustment operation, may initially be tight to raise and lower when new. This is normal and standard factory tolerance setting.

To achieve smooth operation raise and lower the backrest multiple times before using the chair.

